

PIER 15

FOUR BED TOWN HOUSES

PIER STREET

PLYMOUTH



PIER 15





TOWNHOUSES

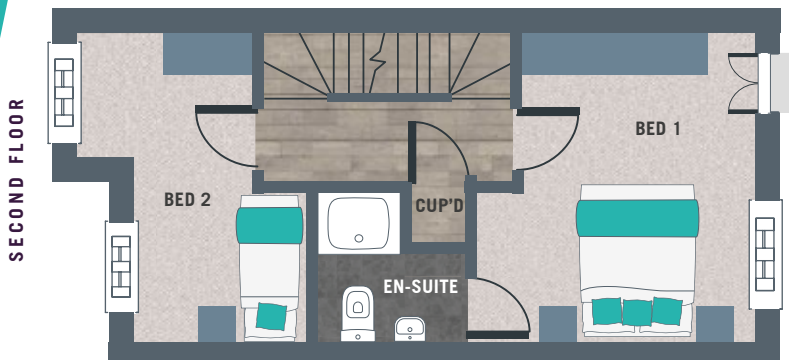
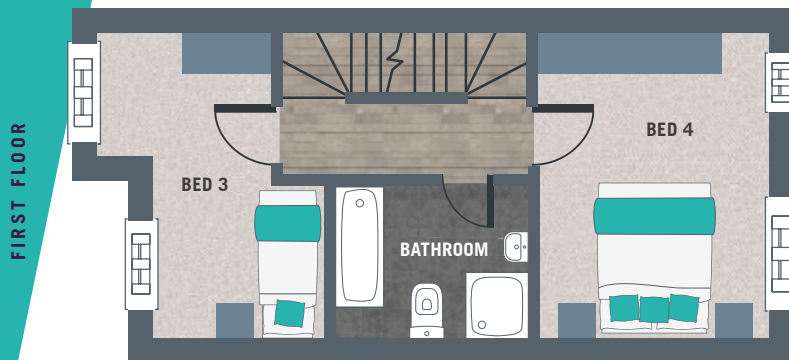
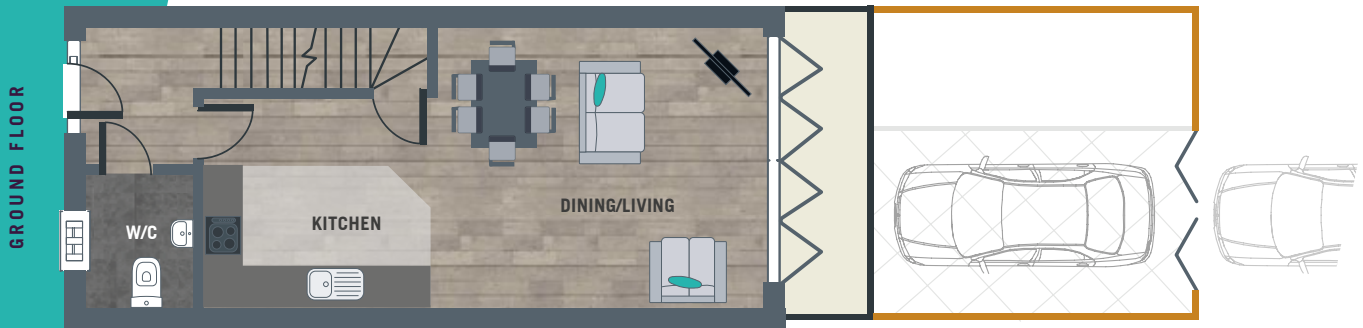

DIMENSIONS

GROUND FLOOR

Kitchen / Sitting Room -	8.5m x 4.2m
WC -	1.6m x 2m

FIRST FLOOR

Bedroom THREE -	4.2m x 2.3m
Bedroom FOUR -	4.2m x 3.1m
Bathroom -	2.7m x 2m

SECOND FLOOR

Bedroom ONE -	4.2m x 3.7m
En-Suite -	2m x 2.1m
Bedroom TWO -	4.2m x 2.3m

SPECIFICATION

- Gas central heating
- PV Panels
- Glazed balustrade to stair cases
- Engineered oak floor to the reception room
- Kitchen's and bathrooms supplied by Mayflower Kitchens
- Private parking space for each property
- Patio and Grasscrete to the rear of property

Floorplans, room dimensions, layout and furniture are indicative only, based on documents correct at time of going to print and will be subject to review and optimisation. Whilst the information is believed to be correct its accuracy cannot be guaranteed and does not form part of any contract. They are intended to be used for carpet sizes, appliances sizes or items of furniture.

premier
guarantee

FOR ALL ENQUIRIES

CALL **01752 200909**

waterside@langtownandcountry.com

**LANG TOWN
& COUNTRY**
LAND & NEW HOMES